



12x16 Backyard Retreat

Call Toll-Free: (866) 297-3760

This little cottage was originally designed as a playhouse for a child in Pennsylvania. A joint effort between the client and our staff, this little retreat is in a league of its own. The six windows and 9-light door fill this sanctuary with natural light. Whether it is a child's playhouse, an artist's studio or just a quiet retreat away from the main house, this building exudes enough charm and comfort to make anyone feel at home.

All of our wood sheds, storage sheds, garden sheds, cottages and utility enclosures are built of the finest Vermont lumber and handcrafted for long life and durability.

Included with kit:

- *All Fastening Hardware
- *Step-by-Step Plans

Specifications:

- Square Footage:** 156 sq ft, 120 sq ft interior
- Overall Dimensions:** 13'2" W x 17'2" L x 10' 6" H
- Recommended Foundation:** 6"-8" Crushed Gravel
- Floor:** Two 4x6x12 Hemlock Skids
One 4x4x16 Hemlock Skid
2x6 Hemlock Floor Framing 24" on Center
3/4" CDX Plywood Interior Flooring
4/4 Rough Sawn Hemlock Decking on Porch
- Walls:** 4x4 Post & Beam Wall Framing
59" Wall Height
- Doors:** Single 3'-0" x 6'8" 9-light Door with 16"x21" fixed window, no ramp
- Siding:** 1" Pine Board and Batten Siding
1" Rough Sawn Pine Corner, Door & Window Trim
2" Rough Sawn Pine Fascia & Shadow Trim
- Windows:** Two-2x2 Hinged Barn Sash Windows
One-4x2 Double Hinged Window
- Roof:** 2x6 Rafters 24" on Center
8/12 Pitch Corner Gable Roof with Flying "V" Porch
1" Rough Sawn Pine Solid Sheathing
1x6 Rough Sawn Hemlock Collar Ties
29 Gauge Evergreen Corrugated Metal Roofing
- Porch:** 36 Sq. Ft. Porch with Treated Newell Post
- Estimated Weight:** 7000 lbs
- Cube Size:** 1@42" H x 48" W x 192" L
1@42" H x 48" W x 120" L
- Estimated Assembly Time:** 2 people, 36 hours
Pictures may reflect client upgrades and modifications that do not come standard. Be sure to read the standard written specs below and check out the floor plan on the right for the standard option. Cottage Associates can be reached via phone or email if you have any questions.

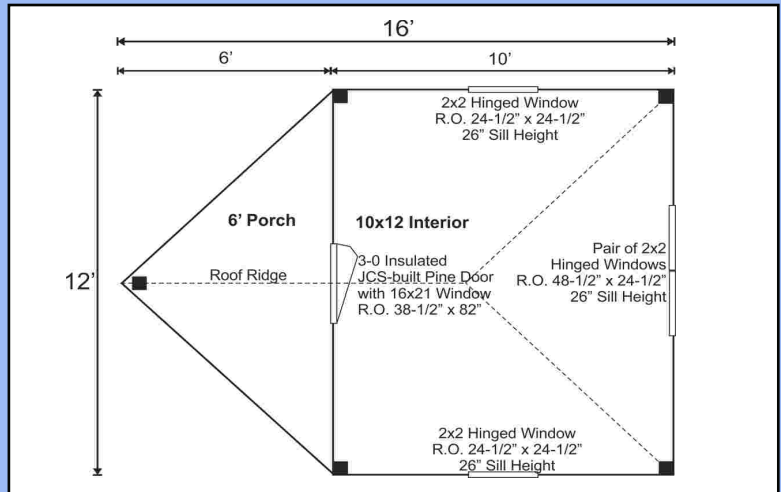

Additional Options

3 or 4 Season Packages
Additional Siding and Roofing Choices Possible

Plans

Jamaica Cottage Shop, Inc. designed these plans for do-it-yourself homeowners. The detailed plans include foundation options, a shopping list, and a color coded cut list. The trigonometry of the roof triangles has all been simplified with tracing the cut-out roof templates. The plans are set for full dimensional lumber and provide a clear step-by-step path.

Complete Kit

The rough sawn native Vermont lumber package has all the pieces cut and ready for assembly. The fasteners, hardware, windows, and doors are included as well as the step by step plans. The kit is geared to a do-it-yourself homeowner with a basic knowledge of carpentry.