



# 10x20 Vermonter

Call Toll-Free: (866) 297-3760

Jamaica Cottage Shop has designed a building to compete with the pre-fabricated tinker toy sheds found at franchise home supply super stores. We are pleased to offer this popular post and beam design. The 5'0" double doors are large enough to fit a riding lawn mower, ATV, or a couple motorcycles. The versatile shed has been used in many ways from general storage to a play house or turned into a great little potting shed tucked away by the garden. No Plywood is used in the Vermonter. It is built the same way they've been for centuries with native Vermont Lumber.

Rugged post and beam techniques passed down through the centuries are being applied to pre cut and notch this storage shed kit into a sturdy picturesque out-building reminiscent of old New England. The kit is hand made with rough sawn hemlock and pine lumber, the package includes all fastening hardware, metal roofing and step by step plans.

The kit is designed for a novice wood worker with basic skills. Technical support is provided via our toll free support line. The cottage shed kit takes approximately twenty eight hours to assemble. Step by step cottage plans may be purchased separately which include a material shopping list to provide your own rough cut lumber. The cottage kit in the picture has been stained and customized with red cedar shingle roofing.

- Included in the kit:**
- \* All Fastening Hardware
  - \* Step-by-Step Plans

### Specifications:

**Foundation Recommendation:** 6"-8" Crushed Gravel.

**Overall Dimensions:** 8'6" H x 20'6" L x 10'6" W

**Floor:** Two 6x6x20' Hemlock Skids  
2x4 rough sawn Hemlock Joists 24" on Center  
1" Square Edge Hemlock Board Floor Decking

**Walls:** 4x4 Hemlock Post & Beam Wall Framing  
4x4 rough sawn Hemlock Angle Braces  
Wall Height 62"

**Doors:** 5'0" JCS-built rough sawn 2" thick Pine Double Doors w/ 3x5 Pressure Treated Ramp

**Roof:** 2x4 rough sawn Hemlock Rafters 24" on Center  
1" Strapping 20" on Center  
5/12 Pitch Gable Roof  
Corrugated 29g Metal Roofing; Color: Evergreen

**Siding:** 1" rough sawn Pine Board (*No Battens*)  
1" rough sawn Pine Corner & Fascia Trim

**Kit Weight:** 5,000 lb

**Shipping Cube Size:** 42" x 48" x 144"

**Assembly Time:** Two People, 20 hours

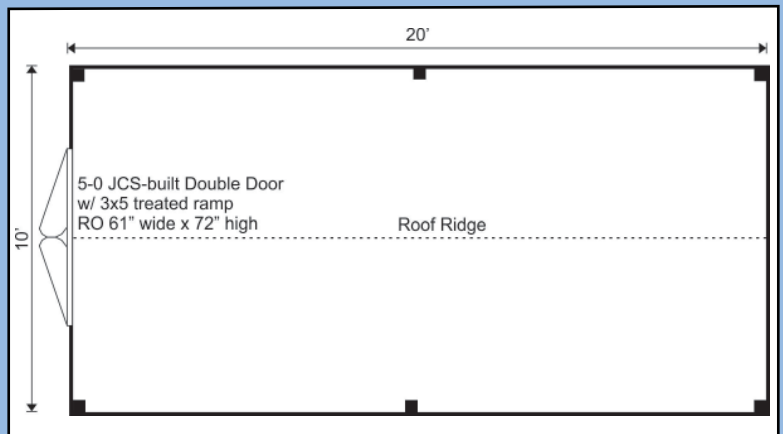

*Pictures may reflect client upgrades and modifications that do not come standard. Be sure to read the standard written specs below and check out the floor plan on the right for the standard option. Cottage Associates can be reached via phone or email if you have any questions.*

**Additional Options**

16" On-Center Floor Joists  
Add Battens • Add Cupola • Add Center Skid  
Roof Color Change

**Plans**

Jamaica Cottage Shop, Inc. designed these plans for do-it-yourself homeowners. The detailed plans include foundation options, a shopping list, and a color coded cut list. The trigonometry of the roof triangles has all been simplified with tracing the cut-out roof templates. The plans are set for full dimensional lumber and provide a clear step-by-step path.

**Complete Kit**

The rough sawn native Vermont lumber package has all the pieces cut and ready for assembly. The fasteners, hardware, windows, and doors are included as well as the step by step plans. The kit is geared to a do-it-yourself homeowner with a basic knowledge of carpentry.