

BILL TO: JCS INVENTORY

SHIP TO: JCS ORDERS

Jamaica Cottage Shop Inc.
 Voice 802-297-3760
 FAX 802-297-2825
 170 Winhall Station Rd
 S Londonderry, VT 05155



Stock# 18-6984

INVOICE #	DESIGNER	INVOICE DATE	SHIP DATE	OFFER CODE
CUSTOMER #	APPROVED BY	BALANCE PAID DATE	SHIP VIA	COMMISSION
1	Fully Assembled 10x16 Sugar Shack			-
2	Overall Height: 14'4"			-
	Skids: 6x6 Hemlock			-
	Recommended Foundation: 6"-8" Crushed Gravel			-
	Floor Joists: 2x6 rough sawn Hemlock; 24" on center			-
	Floor System Rating: 25 lbs/ sq. ft.			-
	Flooring Material: 3/4" CDX Plywood Decking			-
	Wall Frame: 4x4 Hemlock Post & Beam			-
	Rafters: 2x6 rough sawn Hemlock; 24" on center			-
	Siding: 1" rough sawn Pine Board & Battens			-
1	Roofing: Corrugated: PATRICIAN BRONZE			-
1	Double 5-0 JCS-built rough sawn Pine Doors w/3x5 treated ramp, no windows			-
2	3x2 eight-lite Hinged Barn Sash Windows			-
1	Wood Louvered Vent			-
1	4x8 JCS-built rough sawn Pine Cupola - upgrade to Functional			-
1	3x2 eight-lite Hinged Barn Sash Windows			-
1	Single 2'6" JCS-built rough sawn Pine Door; no ramp, no windows			-
-1	Production Notes: standard upgrade to Functional Cupola			-
	Delivery Installation: Building Rests on (6) points: (6) 4x8x16" solid concrete blocks supplied by driver. If additional blocks are required to level the building due to improper, unlevel site preparation, additional blocks used will be charged at \$10 /each (due on delivery)			-
			SUBTOTAL	\$ -
			DISCOUNT	
			SHIPPING & HANDLING	
			DIESEL SURCHARGE	
			SUBTOTAL	\$ -
			TAX RATE	
			SALES TAX	\$ -
			CUPOLA REASSEMBLY	
			TOTAL	
			DEPOSIT RECEIVED	
			BALANCE DUE	\$ -
			PAYMENT METHOD	



INVOICE

SUBTOTAL	\$ -
DISCOUNT	
SHIPPING & HANDLING	
DIESEL SURCHARGE	
SUBTOTAL	\$ -
TAX RATE	
SALES TAX	\$ -
CUPOLA REASSEMBLY	
TOTAL	
DEPOSIT RECEIVED	
BALANCE DUE	\$ -
PAYMENT METHOD	

Deposit places order; Balance Due on Shipping
 Estimated time frame is calculated from the date of your order confirmation.
 Cash, Check, PayPal, Visa, MasterCard, Discover, & Amex accepted. Once building plans are set, there is a \$250 fee for discussing changes, \$120/hour per man plus material. Your order is fully refundable if cancelled within **3 days**. Otherwise all of your deposit will be refunded except 25% of the total building cost. All cancelled or returned orders paid by credit card will be subject to an additional credit card processing charge of 3%. Please allow 5 to 10 business days for processing. Standard cancellation policies will remain in effect for buildings on hold.
 Pictures may be of client-modified projects and do not depict standard designs – pics may reflect windows, doors, siding, hardware, etc not included in the standard design. Please refer to the spec sheet online for details on the design's standard specifications.
 The site and truck path are to be cleared of any unnecessary obstacles. JCS allows a 3 hour window for delivery; anything over 3 hours is subject to a charge of \$250/hr billed in 15-minute increments. Additional shipping fees may apply for bridge crossings, ferries, and extreme urban or rural areas. To learn more about our delivery and site prep policy, please review our FAQ's on our website.
 Thank you for your interest in Jamaica Cottage Shop, Inc. Your business is appreciated.
 Please contact us if you have any questions or concerns.

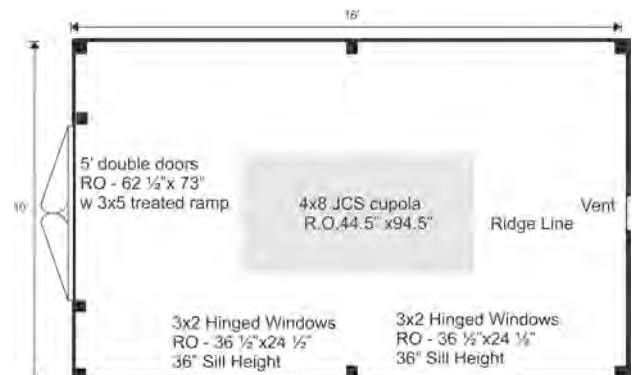

www.JamaicaCottageShop.com