



4x4 Bus Stop

Call Toll-Free: (866) 297-3760

Do you remember walking uphill to school in a snow storm, both ways! Well kids these days may have it a bit easier, but waiting for the bus in the rain, wind and cold can be very unnerving for a parent. Put your worries to rest knowing that the children will be huddled in this bus stop shelter. Easily customizable by adding a bench, window, door, or by expanding to a bigger size.

Hand made in Vermont, from native rough sawn hemlock and pine lumber, this cottage is delivered fully assembled to your prepared site. Rugged post and beam techniques, passed down through the centuries are used to construct this sturdy, picturesque, retreat reminiscent of old New England.

All of our wood sheds, storage sheds, garden sheds, storage shed kits, cottages and utility enclosures are built of the finest Vermont lumber and handcrafted for long life and durability. New England weather can really put a wood garden shed or cottage to the test, and Jamaica Cottage Shop's products have proven to stand the test of time and strength.

- Included in the kit:**
- * All Fastening Hardware
 - * Step-by-Step Plans

Specifications:

Square Footage: 16 sq ft

Overall dimensions: 4'10" wide x 6'5" long x 8'6" high

Recommended Foundation: 3" – 4" Crushed Gravel

Floor: Two 4x4x4' Hemlock Skids

2x6 rough sawn Hemlock; 24" on center

1" Rough Sawn Square Edge Hemlock Board Floor

Walls: 4x4 Post & Beam Wall Framing

80" Front Wall Height 50" Rear Wall Height

Roof: 2x6 rough sawn Hemlock Rafters 24" on center

8/12 Saltbox Roof Pitch, 10" Front Roof Overhang

1x4 Strapping 20" on center

Corrugated 29g Metal Roofing, Color: Evergreen

Siding: 1" rough sawn Pine Board Siding (no battens)

1" rough sawn Pine Trim includes Fascia, Shadow,

Corner, and Door Trim

Bench: 4' Long x 18" Deep x 14" High rough sawn Pine Bench

Assembly Time: One person, 10 hours

Shipping Cube Size: 42" W x 28" H x 96" L

Kit Weight: 900 lbs

Pictures may reflect client upgrades and modifications that do not come standard. Be sure to read the standard written specs below and check out the floor plan on the right for the standard option. Cottage Associates can be reached via phone or email if you have any questions.

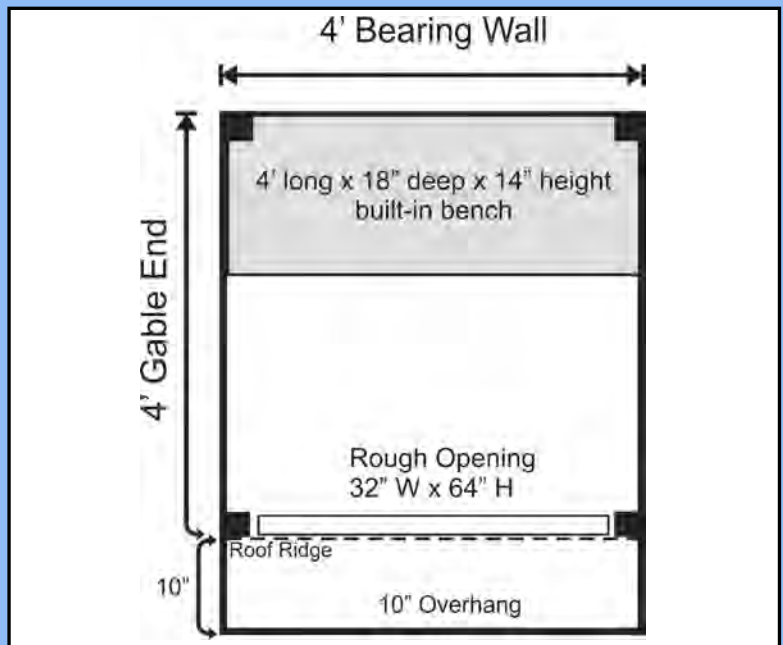

Plans

Jamaica Cottage Shop, Inc. designed these plans for do-it-yourself homeowners. The detailed plans include foundation options, a shopping list, and a color coded cut list. The trigonometry of the roof triangles has all been simplified with tracing the cut-out roof templates. The plans are set for full dimensional lumber and provide a clear step-by-step path.

Complete Kit

The rough sawn native Vermont lumber package has all the pieces cut and ready for assembly. The fasteners, hardware, windows, and doors are included as well as the step by step plans. The kit is geared to a do-it-yourself homeowner with beginner knowledge of carpentry.