



4x12 Woodbin

Call Toll-Free: (866) 297-3760

Start the wood-burning season off right! Old timers here in Vermont say “get your wood stacked by Labor Day”. The best way to cure firewood is to keep it dry and allow the air to pass through it. The Woodbin design does just that, not to mention it is attractive and practical for firewood storage.

A cord of firewood measures 4x4x8 or 128 cubic feet. The cottage is designed to hold a cord plus of wood. A partition sanctions off two feet of the floor space for kindling and a few hand tools. The woodbin has a heavy 2x6 floor frame and is sided with 1” rough sawn pine board. The saltbox roof will shed the majority of the snow off the back and out of the way.

Hand made in Vermont, from native rough sawn hemlock and pine lumber, the woodbin is ready to be stacked full. Rugged post and beam techniques passed down through the centuries are being applied to create a sturdy dry wood storage shed. It is built the same way they have been for centuries with native Vermont Lumber.

Pictures may reflect client upgrades and modifications that do not come standard. Be sure to read the standard written specs below and check out the floor plan on the right for the standard option. Cottage Associates can be reached via phone or email if you have any questions.

- Included in the kit:**
- * All Fastening Hardware
 - * Step-by-Step Plans

Specifications:

Square Footage: 48 sq/ft

Overall Dimensions: 6’5”D x 12’6” W x 8’6” H

Recommended Foundation: 3”-4” Crushed Gravel

Floor: Two 4x6x12’ Hemlock Skids

2x6 rough sawn Hemlock Floor Joists; 24” on center
1” rough sawn Hemlock Board Floor Decking

Walls: 4x4 Post & Beam Wall Framing

Front Height 80” Rear Height 50”

Roof: 2x6 rough sawn Hemlock Rafters; 24” on center

1x4 Strapping 20” on center

8/12 Saltbox Roof Pitch

10” Overhang in Front, Overhang in Rear

Corrugated 29g Metal Roofing, Color: Evergreen

Siding: 1” rough sawn Pine Board Siding

1” rough sawn Pine Trim includes Corner Boards,
Rear Fascia, and Shadow Boards

Kit Weight: 1,800 lbs

Shipping Cube: 42” wide x 32” high x 144” long

Assembly Time: One Person 16 Hours

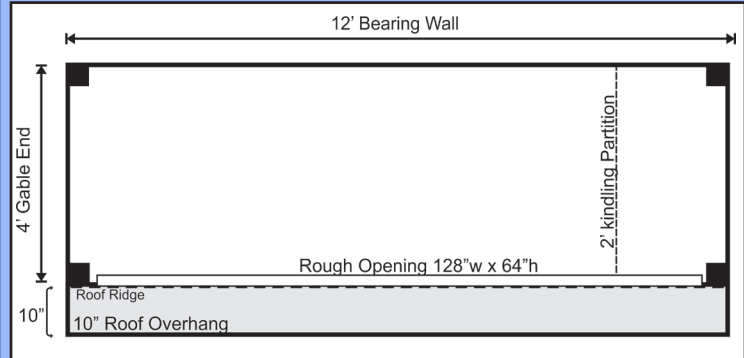

Plans

Jamaica Cottage Shop, Inc. engineered the plans for our designs to do-it-yourself homeowners. The detailed plans include foundation options, a shopping list, and a color coded cut list. The trigonometry of the roof triangles has all been simplified with tracing the cut out roof templates. The plans are set for full dimensional lumber and provide a clear step-by-step path.

Complete Kit

The rough sawn native Vermont lumber package has all the pieces cut and ready for assembly. The fasteners, hardware, windows, and doors are included as well as the step by step plans. The kit is geared to a do-it-yourself homeowner with beginner knowledge of carpentry.

Fully Assembled

Fully assembled from native rough sawn lumber here at our manufacturing facility, this design is delivered to your client prepared, truck accessible site in one piece. The building is set and leveled by our delivery crew and ready to use when we leave your site. Due to road restrictions, fully assembled models are available in the northeastern United States only. Customizable using our Option Pricing on our website.