



# 14 x 20 Camping Cabin

This cozy cabin is the perfect solution for your isolated New England property. An enchanting three-room cottage, complete with a bathroom is a wonderful place to relax and escape from the hustle and bustle of everyday life. The kitchen is equipped with a gray water sink and built in counter and cabinet space. The 12" wood stove and the wall mounted propane heater allows this cabin to remain a place of comfort even in the cold New England winters. The building also comes equipped with a solar panel camping package which allows this cottage to be completely self sufficient.

Hand made in Vermont, from native rough sawn hemlock and pine lumber, this cottage is delivered fully assembled to your prepared site. Rugged post and beam techniques, passed down through the centuries, are used to construct this sturdy picturesque retreat, reminiscent of old New England. Have your own Vermont cabin in the woods!

Furniture is not included.

We also offer this camping cabin in it's stripped down form for those of you who would rather complete the interior of your cottage yourself.

### Specifications:

**Square Footage:** 280 sq/ft

**Overall Dimensions:** 14'8" W x 20' L x 10' 6" H

**Wall Height:** 70"

**Recommended Foundation:** 6"-12" Crushed Gravel

**Floor:** (4) 4x6x14' Hemlock Skids; 2x6 Hemlock Floor Framing 24" on center; 2x6 Pine T&G Interior Flooring; 12x14 Living Area; 8x11 Bedroom; 3x8 Bathroom

**Walls:** 2x4 rough sawn Hemlock 24" on center

**Doors:** (1) nine-lite Insulated Steel Door

(2) 2'-8" Pine Interior Four-Panel Doors

**Windows:** (4) 3x3 Insulated Double Hung Windows w/Screens

(1) 2x3 Insulated Double Hung Window w/Screen

**Roof:** 2x6 rough sawn Hemlock Rafters 24" on center; 1x4 Roof Strapping 20" on center; 5/12 Gable Roof Pitch; 6" Matching Over-hang on all 4 Sides; Corrugated Metal Roofing 29g; Evergreen

**Siding:** 1" rough sawn Pine Board & Battens; 1" rough sawn Pine Trim for Corner Boards; 2" rough sawn Pine Trim includes Fascia, and Shadow Boards; No Soffit

**Interior Sheathing:** Walls & Ceiling: 1" Shiplap Pine

**Insulation:** Floor: 5-1/2" Fiberglass R-19 with 3/8" Ply and Vapor Barrier; Walls: 3-1/2" Fiberglass R-11 with Vapor Barrier; Roof: 5-1/2" Fiberglass R-19 with Vapor Barrier

**Plumbing:** Gray Water System: Sink; 3x3 Shower; Envirolet Composting Toilet

**Electric:** Solar Power Panel Camp Package; Hardwired Smoke Detector with Battery Back-up; (3) Outlets; (3) Energy Efficient Low Wattage Light Bulbs w/Pull Chains

**Heating:** 6" Stovepipe Thimble through Roof; 12" Wood Stove with Window; Propane Wall Mounted Heater

**Storage:** 6' In.ft. rough sawn Pine 30" Workbench w/Shelf Above and Cabinets Below; 1'w x 3' long Smooth Pine Bench w/Flip Lid - Battery Back up Storage Area

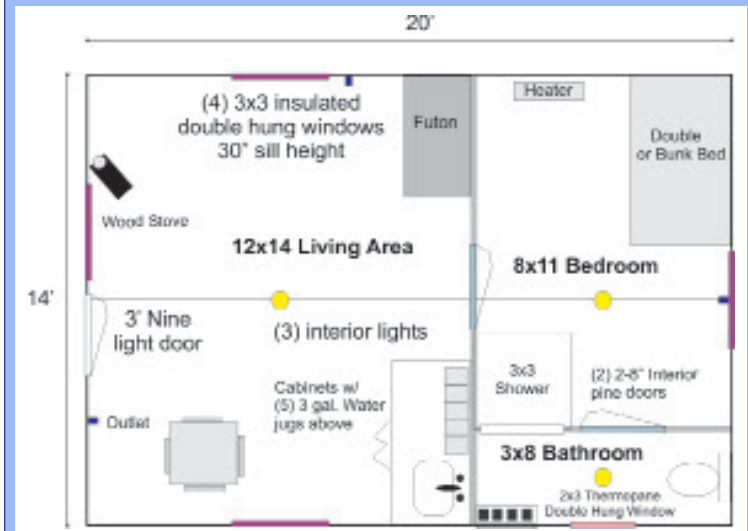

**Plans \$50.00**

Jamaica Cottage Shop, Inc. engineered the plans for our designs to do-it-yourself homeowners. The detailed plans include foundation options, a shopping list, and a color coded cut list. The trigonometry of the roof triangles has all been simplified with tracing the cut out roof templates. The plans are set for full dimensional lumber and provide a clear step-by-step path.

**Fully Assembled \$35,504**

Cabin will be delivered, fully assembled by our in house delivery crew. Due to road restrictions, the Cabin is only available in Northern New England. Contact our client care team to find out if this rustic retreat can be delivered to your property.