



# 10x16 New Yorker

Call Toll-Free: (866) 297-3760

The New Yorker design was derived from our Vermonter design. Like the Vermonter, this building is your basic outdoor storage shed. The 5 ft. double doors have been moved to the bearing wall and the overall height has been raised to allow for this change. The shed is perfect to fit your storage needs and cure the over flowing garage.

This outbuilding's 5'0" double doors are large enough to fit a riding lawn mower, ATV, or a couple motorcycles. The versatile shed has been used in many ways from general storage to a play house or turned into a great little potting shed tucked away by the garden.

No Plywood is used in the New Yorker. It is built the same way they have been for centuries with native Vermont Lumber. Available in Option A with the double doors on the 14' bearing wall and in Option B with the double doors on the 10' gable end.

**Included with Kit:** \* Step-by-Step Plans  
\* All Fastening Hardware

## Specifications

**Square Footage:** 140 sq/ft

**Overall Dimensions:** 10'6" H x 10'8" W x 16'8" L

**Recommended Foundation:** 3"-4" Crushed Gravel

**Floor:** Two 4x6x16' Hemlock Skids

2x4 rough sawn Hemlock Joists; 24" on center

1" rough sawn Hemlock Board Floor

**Walls:** 4x4 Post & Beam Wall Framing

2x6 rough sawn Hemlock Exposed Collar Ties

Wall Heights: 86"

**Doors:** Double 5'-0" JCS-built rough sawn Pine

Doors with 3x5 Treated Ramp

**Roof:** 2x4 rough sawn Hemlock Rafters 24" on center

5/12 Gable Roof Pitch

1" rough sawn Pine Strapping; 20" on center

Corrugated Metal Roofing: 29g, Evergreen

**Siding:** 1" rough sawn Pine Board Siding

**Trim:** 1" rough sawn Pine Fascia, Corner, Door Trim

**Assembly Time:** One Person, 22 hours

**Kit Weight:** 3200 lbs

**Shipping Cube Size:** 192" L x 43" W x 38" H



Option A

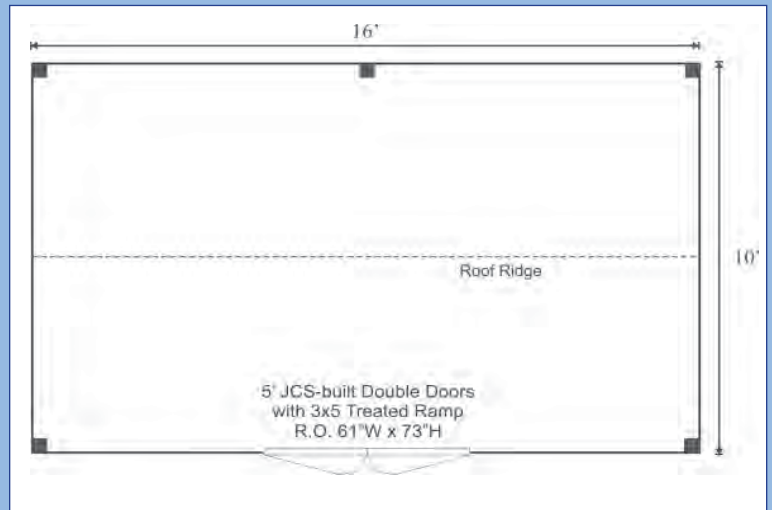

### Fully Assembled

Fully assembled from native rough sawn lumber here at our manufacturing facility, this design is delivered to your client prepared, truck accessible site in one piece. The building is set and leveled by our delivery crew and ready to use when we leave your site. Due to road restrictions, fully assembled models are available in the northeastern

### Plans

Jamaica Cottage Shop, Inc. engineered the plans for our designs to do-it-yourself homeowners. The detailed plans include foundation options, a shopping list, and a color coded cut list. The trigonometry of the roof triangles has all been simplified with tracing the cut out roof templates. The plans are set for full dimensional lumber and provide a clear step-by-step path.

### Complete Kit

The rough sawn native Vermont lumber package has all the pieces cut and ready for assembly. It includes cut and notched hemlock post and beam frame and pre cut pine siding. The fasteners, hardware, windows, and doors are included as well as the step by step plans. The kit is geared to a do-it-yourself homeowner with beginner knowledge of carpentry.

Option B

