



# 8x18 Heritage

Call toll-free: 1.866.297.3760

This design is one of my favorites. It is in response to the many who have asked for a multi purpose building that will keep both happy. It took a year and twelve revisions before this design was finalized. It makes very good use of the space while providing an aesthetically pleasing appearance. The 5' double doors on the gable end are adequate for a lawn tractor, ATV, and/or firewood storage. With the addition of a workbench and cabinet space, the interior 8x10 can easily be converted into a potting area or workshop.

An interior door set into the partition closes off the 8x10 storage area, while providing easy access between the two sides of the building. This design can be made into a living model and/or a different floor plan can set up for its intended use. Contact our client care team to learn how to make this design work for you.

All of our wood sheds, storage sheds, garden sheds, cottages and utility enclosures are built of the finest Vermont lumber and handcrafted for long life and durability. New England weather can really put a wood garden shed or cottage to the test, and Jamaica Cottage Shop's products have proven to stand the test of time.

### Specifications:

**Square Footage:** 160 sq ft

**Overall dimensions:** 11'2" W x 19'2" L x 10'6" H

**Recommended Foundation:** 6" – 8" Crushed Gravel

**Floor:** Two 6x6x18 Hemlock Skids

2x6 Hemlock 24" on Center

3/4" CDX Plywood Floor

2x8 Pop Out on Potting Side

8x10 Potting Side 8x10 Storage Side

**Walls:** 4x4 Post and Beam Wall Framing

Wall Height 82"

8' Interior Partition

**Wood Louvered Vent**

**Doors:** Double 5-0 JCS built Door with Treated Ramp on Storage Side

Single 3-0 JCS built Door on Potting Side

Single 2-8 JCS built Door in Partition

**Windows:** Two 2x2 six-light Hinged Barn Sash Windows

One 2x3 eight-light Hinged Barn Sash Window

**Roof:** 6/12 Roof Pitch

2x6 Rafters 24" on Center

1x4 Roof Strapping 20" on Center

1x6 Rough Hemlock Exposed Collar Ties

Green Corrugated Metal Roofing

**Siding:** 1" Thick Board and Batten Siding

1" Rough Sawn Pine Trim for Corner Boards, Door & Window Trim

2" Rough Sawn Pine Trim for Gable Fascia, and Shadow Boards

Boards

**Total Weight:** 5400 lbs

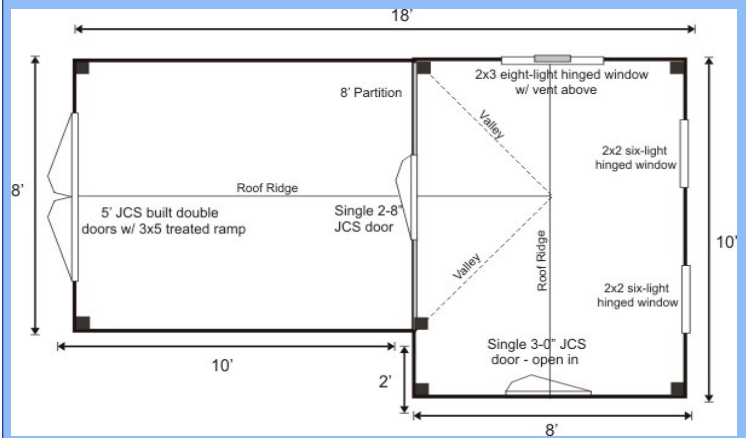

**Fully Assembled \$6,768**

Fully assembled from native rough sawn lumber here at our manufacturing facility, this design is delivered to your client prepared, truck accessible site in one piece. The building is set and leveled by our delivery crew and ready to use when we leave your site. Due to road restrictions, fully assembled models are available in the northeastern United States only.