



12 x 14 Writer's Haven

Call toll-free: 1.866.297.3760

Imagine having your own private Writer's Haven: A place to be alone with your thoughts. Just as Henry David Thoreau had his cabin on Walden Pond, you too could have a sanctuary of your very own. With the translucent roofing and the abundance of windows, the natural light that fills this room is ideal for spending long days writing, reading, painting or simply relaxing. Complete with a daybed, this little hideaway is a great place to take a summer siesta. The built in desk provides an ideal workspace regardless of your artistic pleasure and the cottage itself emanates inspiration.

Specifications:

Square Footage: 132 sq ft, 96 sq ft Interior
Overall Dimensions: 13'2" W x 15'2" L x 10' 6" H
Foundation Recommendation: 4"-6" Crushed Gravel

Floor: Two 4x6x8 Hemlock Skids
One 4x4x14 Hemlock Center Skid
2x6 Hemlock Floor Framing 24" on center
2x6 Tongue & Groove Interior Flooring
2x6 Rough Sawn Hemlock Decking on Porch

Walls: 4x4 Post & Beam Wall Framing
36" Wall Height

Doors: Single 3-0 15-light Steel French Door
Single 3-0 exterior screen door

Siding: 1" Pine Board and Batten siding
1" Rough Sawn Pine Corner boards,
Door & Window Trim
Rough Sawn Pine Fascia & Shadow Trim

Windows:
(4) 2x2 Hinged Barn Sash Windows
16x21" Hinged Barn Sash Window
16x21" Fixed Barn Sash Window
16" Stain Glass Roundel
Screens for all Hinged Windows

Roof: 2x6 Rafters 24" on Center
12/12 Pitch Gable Roof with Flying "V" Porch
18/12 Pitch Dormer
1x4 Roof Strapping 20" on Center
2x6 Rough Hemlock Exposed Collar Ties
29 Gauge Corrugated Metal Roofing, Evergreen
3x5 Translucent Roofing Panel
Translucent Roofing Over Porch

Porch: 36 Sq. Ft. Porch with One Half-Newel Post

Built in Storage: Built-in Desk 28"Hx24"Dx96"L
Built-in Daybed 16"Hx27"Dx96"L
30" Built-in Wooden Dowel Rack

Estimated Weight: 4200 lbs

Assembly Time: Two People 30 Hours

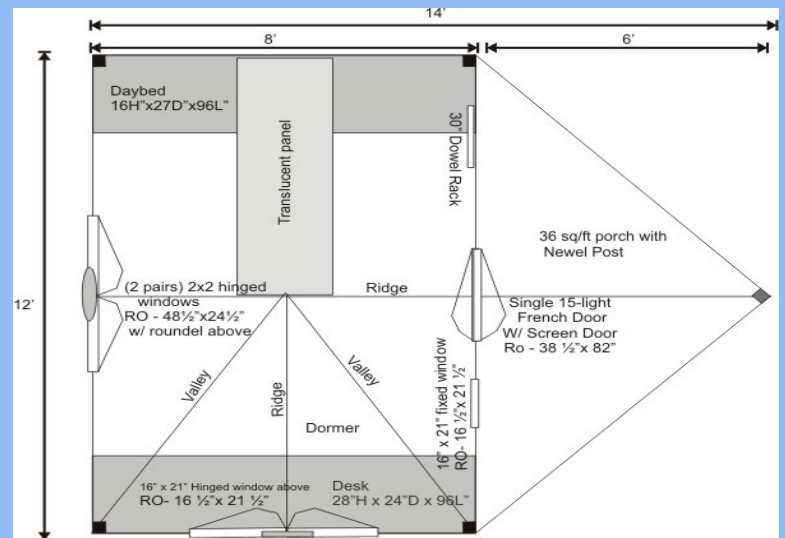

Plans \$50.00

Jamaica Cottage Shop, Inc. engineered the plans for our designs to do-it-yourself homeowners. The detailed plans include foundation options, a shopping list, and a color coded cut list. The trigonometry of the roof triangles has all been simplified with tracing the cut out roof templates. The plans are set for full dimensional lumber and provide a clear step-by-step path.

Complete Kit \$7,958

Fully assembled from native rough sawn lumber here at our manufacturing facility, this design is delivered to your client prepared, truck accessible site in one piece. The building is set and leveled by our delivery crew and ready to use when we leave your site. Due to road restrictions, fully assembled models are available in the northeastern United States only.