



# 12 x 12 Saltbox

Call toll-free: 1.866.297.3760

By far the most popular design, the salt box begs the word traditional. This extremely versatile cottage has a very rugged Hemlock frame that will withstand the test of time. With 144 square feet of usable space, this building easily lends itself to basic storage, a potting shed or parking for your outdoor toys.

The salt box design originated in New England shortly after the pilgrims landed. The design most likely originated from a shed roof style. An overhang off the front was added for protection and style. It has proved to be a very aesthetically pleasing and practical design for snow country. Many rural farms can be spotted with homes and out buildings with roofs that shed the majority of snow off the back and out of the way.

All of our wood sheds, storage sheds, garden sheds, cottages and utility enclosures are built of the finest Vermont lumber and handcrafted for long life and durability. New England weather can really put a wood garden shed or cottage to the test, and Jamaica Cottage Shop's products have proven to stand the test of time and strength.

- Included in the kit: • All Fastening Hardware
- Step-by-Step Plans

### Specifications:

- Square Footage:** 144 sq ft
- Overall dimensions:** 13'2" W x 13'10" L x 10'6" H
- Recommended Foundation:** 3" – 4" Crushed Gravel
- Floor:** 4x6x12' Hemlock Skids  
2x6 Rough Sawn Hemlock 24" on center  
3/4" CDX Plywood Floor
- Walls:** 4x4 Post and Beam Wall Framing  
83" Front Wall Height, 63" Rear Wall Height
- Doors:** 5-0 JCS-Built Double Doors with 3x5 Treated Ramp
- Windows:** Two 2x2 Hinged Barn Sash
- Roof:** 2x6 Rough Sawn Hemlock Rafters 24" on center  
1x4 Roof Strapping 20" on center  
2x6 Rough Sawn Hemlock Exposed Collar Ties  
Evergreen Corrugated Metal Roofing
- Siding:** 1" Rough Sawn Pine Board and Battens  
1" Rough Sawn Pine Trim for Front & Rear Fascia & Shadow, Corner Boards, Door & Window Trim  
2" Rough Sawn Pine Trim for Gable Fascia, and Shadow
- Wood Louvered Vent**

- Shipping Cube Size:** 48" W x 44" H x 145" L
- Total Weight:** 4700 lbs
- Estimated Assembly Time:** One Person, 30 hours

### Fully Assembled \$5,531

Fully assembled from native rough sawn lumber here at our manufacturing facility, this design is delivered to your client prepared, truck accessible site in one piece. The building is set and leveled by our delivery crew and ready to use when we leave your site. Due to road restrictions, fully assembled models are available in the northeastern United States only.



Photographs may not depict standard Option A, please see Floor Plan and Specifications to the left.

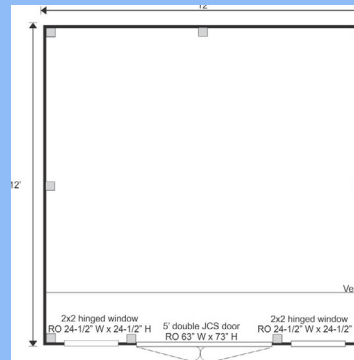

Figure 2



### Plans \$50

Jamaica Cottage Shop, Inc. engineered the plans for our designs to do-it-yourself homeowners. The detailed plans include foundation options, a shopping list, and a color coded cut list. The trigonometry of the roof triangles has all been simplified with tracing the cut out roof templates. The plans are set for full dimensional lumber and provide a clear step-by-step path.

### Complete Kit \$5,531

The rough sawn native Vermont lumber package has all the pieces cut and ready for assembly. It includes a cut and notched hemlock post and beam frame and pre cut pine siding. The fasteners, hardware, windows, and doors are included as well as the step by step plans. The kit is geared to a do-it-yourself homeowner with beginner knowledge of carpentry.