



12x20 Gibraltar

Call toll-free: 1.866.297.3760

The 12x20 Gibraltar is a clever little design that includes a 4x20 porch, an 8x20 interior space and an eye-catching barrel arch at the entrance. The single door is complimented by an additional five foot wide double door on the gable end. The elegant country charm is achieved with the large barn sash windows and rustic board and batten siding and is protected by a green corrugated metal roof. The post and beam frame makes this wooden shed a strong backyard out-building. A sturdy interior work bench has also been included.

This rugged and attractive design is beautiful from the front view. With the large double doors it is very capable of handling all your storage needs. It will make a perfect get-away, garden or potting shed, a reading or writing haven, a pool house or motorcycle work shop.

Included with Kit: * All Fastening Hardware
* Step-by-Step Plans

Specifications:

Square Footage: 240 sq ft/ 160 sq ft Interior

Overall Dimensions: 13'2" W x 21'2" L x 10' 6" H

4'x20' Porch with 8'x20' Interior Space

Recommended Foundation: 8"-12" Crushed Gravel

Floor: Two 6x6x20' Hemlock Skids

2x6 rough sawn Hemlock Joists; 24" on center

3/4" CDX Plywood Floor Decking

1" rough sawn Hemlock Porch Floor Decking

Walls: 4x4 Post & Beam Wall Framing

95" Front Wall Height

71" Rear and Porch Wall Height

Doors: (1) Single 2'-8" JCS-built rough sawn Pine Door with 16x21 Fixed Window, no ramp

Siding: 1" rough sawn Pine Board & Batten

1x4" rough sawn Pine Corner, Door & Window Trim

2x8" rough sawn Pine Fascia & 2x4" Shadow Trim

Windows: Four 3x2 eight-lite Hinged Barn Sash Windows, no screens

Roof: 2x6 rough sawn Hemlock Rafters; 24" on center

Rear Roof Strapping: 1" rough sawn Hemlock 20" oc

Front & Porch Roof: 1" rough sawn Pine Solid Sheathing

Gable Roof Pitch: 6/12 Dormer Pitch: 6/12

Corrugated Metal Roofing; 29 gauge: Evergreen

Porch: 80 sq/ft Porch with Four 4x4 Hemlock Posts

72" Radius Barrel Arch

Work Bench: 8' Long rough sawn Pine Workbench

34" Finish Height 30" Finish Depth

Wood Louvered Vent

Kit Weight: 5800 lbs

Shipping Cube Size: 42"x56"x168"

Assembly Time: 2 People 32 hours

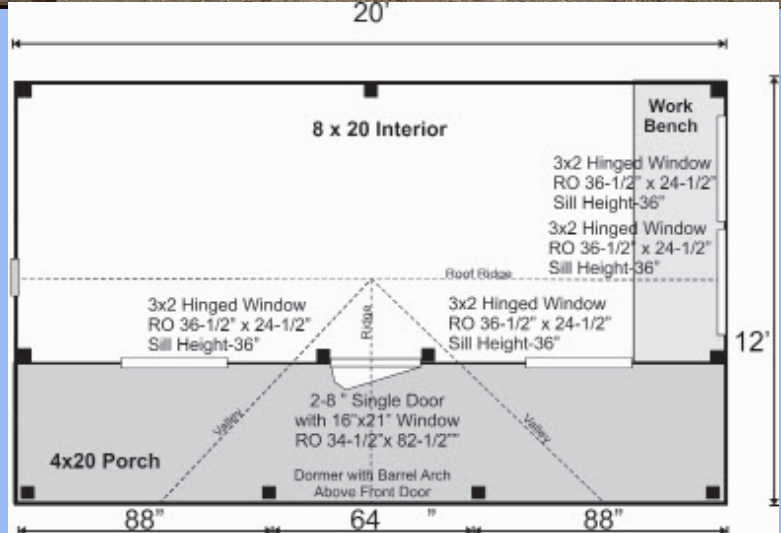

Plans \$39.95

Jamaica Cottage Shop, Inc. engineered the plans for our designs to do-it-yourself homeowners. The detailed plans include foundation options, a shopping list, and a color coded cut list. The trigonometry of the roof triangles has all been simplified with tracing the cut out roof templates. The plans are set for full dimensional lumber and provide a

Pre-Cut Kit \$8,567

The rough sawn native Vermont lumber package has all the pieces cut and ready for assembly. It includes a cut and notched hemlock post and beam frame and pre cut pine siding. The fasteners, hardware, windows, and doors are included as well as the step by step plans.

Additional Options

8' Walls	\$492
5-0 Double doors	\$433
Three Season Insulation	\$1,806
Four Season Insulation	\$5,887